

INDEX OF SHEETS	
SHEET NO.	DESCRIPTION
C1	Title Sheet
C2	Index of Sheets Cont'd & Standard Drg. Nos.

CITY OF SUTHERLIN

PLANS FOR PROPOSED PROJECT

PAVING

TERRACE LANE

ROADWAY IMPROVEMENTS



SUTHERLIN, DOUGLAS COUNTY, OREGON
MARCH 20, 2023

PROJECT SITE

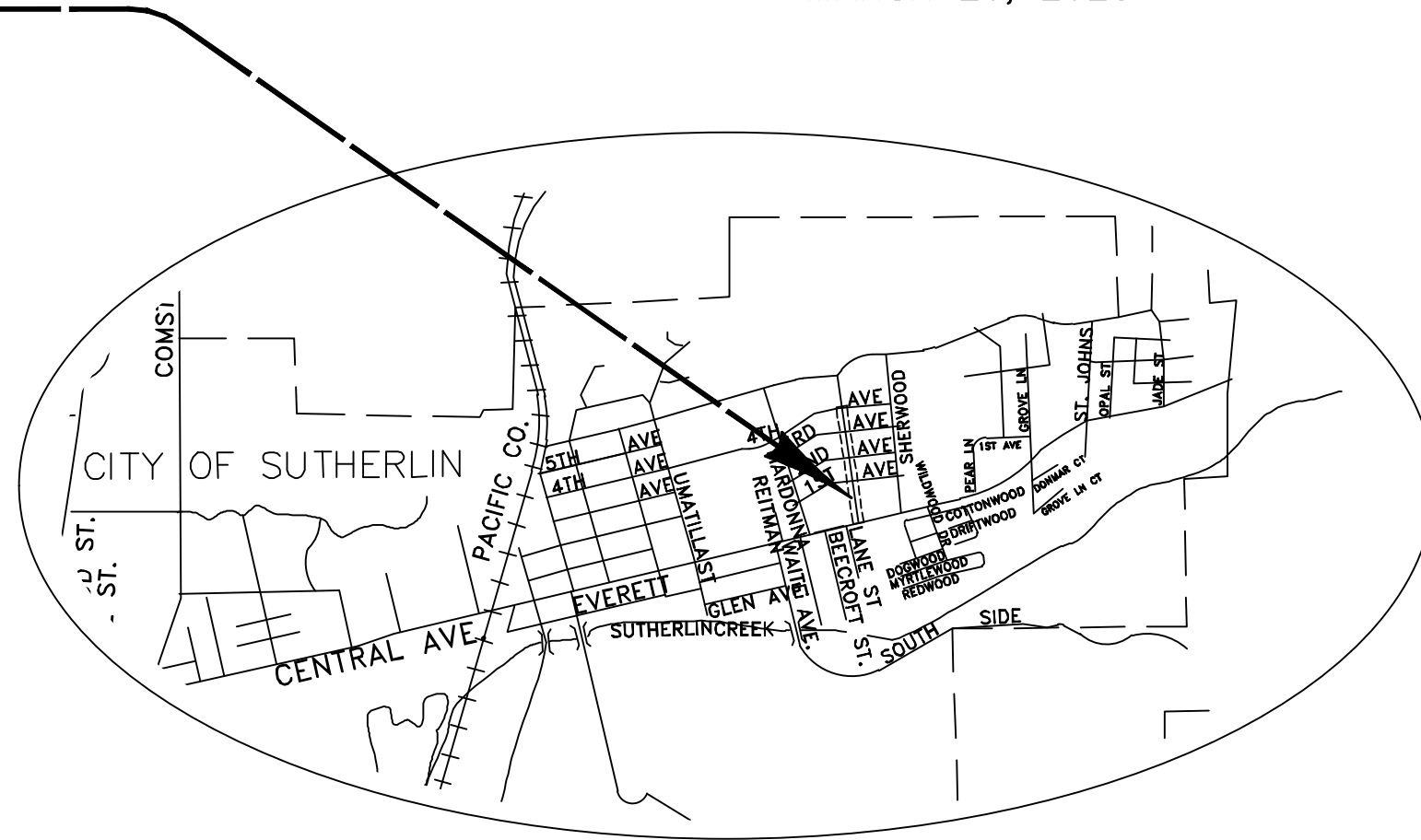

SITE MAP
NTS

PROJECT

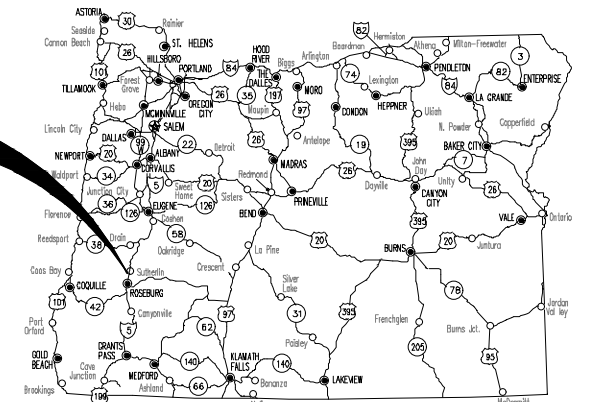

ATTENTION:
Oregon Law Requires You To Follow Rules Adopted By The Oregon Utility Notification Center. Those Rules Are Set Forth In OAR 952-001-0010 Through OAR 952-001-0090. You May Obtain Copies Of The Rules By Calling The Center. (Note: The Telephone Number For The Oregon Utility Center Is (503) 232-1987.)



PLANS PREPARED FOR
SUTHERLIN, OREGON
BY:

ie 809 SE Pine Street Roseburg, Oregon 97470
PHONE (541) 673-0166 FAX (541) 440-9392
iemail@ieengineering.com

TERRACE LANE ROADWAY IMPROVEMENTS SUTHERLIN, OREGON		
	PROJECT NUMBER	SHEET NO.
	1209-33	C1

ROADWAY CONSTRUCTION	
SHEET NO.	DESCRIPTION
C3	Overall General Construction
C4	Construction Notes

Standard Dwg. Nos.

RD258	- Valve Box and Operator Extension
RD360	- Manhole Frame Adjustments
RD700	- Curbs
RD720	- Curb Line Sidewalks
RD722	- Sidewalk Joints and Transition Panels
RD750	- Curb Line Sidewalk Driveways or Alleys (Options M & N) Local Jurisdictions
RD1010	- Inlet Protection Type 2, 3, 6, 7, 10 and 11
TM503	-Pavement Markings Standard Detail Blocks

LEGEND

---(ELEV.)---	EXISTING CONTOUR ELEV.	○	MANHOLE (MH)
——ELEV.——	NEW CONTOUR ELEV.	◻	CURB INLET (CI)
.....	EXISTING EDGE OF AC OR GRAVEL	▤	CATCH BASIN (CB)
---	SAW CUT	•	CLEANOUT
——	EXISTING RIGHT-OF-WAY	⊙	FIRE HYDRANT
——	NEW RIGHT-OF-WAY	⊗	VALVE
——SS——	EXISTING SANITARY SEWER (SS)	▣	WATER METER
——SS——	NEW SANITARY SEWER (SS)	•	BLOWOFF
——PS——	EXISTING PRESSURE SEWER (PS)	⊙	POWER POLE
——PS——	NEW PRESSURE SEWER (PS)	∅	LIGHT POLE
——STS——	EXISTING STORM SEWER (STS)	↙	GUY WIRE
——STS——	NEW STORM SEWER (STS)	▣	POWER PEDESTAL
——W——	EXISTING WATER	▣	TELEPHONE PEDESTAL
——W——	NEW WATER	⊙	GAS METER
——PUG——	EXISTING POWER (UNDERGROUND)	▣	CABLE TV PEDESTAL
——POH——	EXISTING POWER (OVERHEAD)	MAIL	MAIL BOX
——UGU——	NEW UNDERGROUND (TV, POWER, PHONE)	>	FLOW DIRECTION ARROW
——C——	NEW ELECTRICAL CONDUIT	⊙	TREE (EVERGREEN)
——GAS——	EXISTING GAS	⊙	TREE (DECIDUOUS)
——TV——	EXISTING CABLE TV	⊙	DETAIL #
——X——	EXISTING FENCE	⊙	SHEET #
——X——	NEW FENCE	⊙	DETAIL REFERENCE
——	SILT FENCE (S-F)		
TC	TOP BACK OF CURB		
FL	GUTTER FLOWLINE		
AC	ASPHALT		
CONC	CONCRETE		
FF	FINISH FLOOR		
FG	FINISH GRADE		
OG	ORIGINAL GROUND		

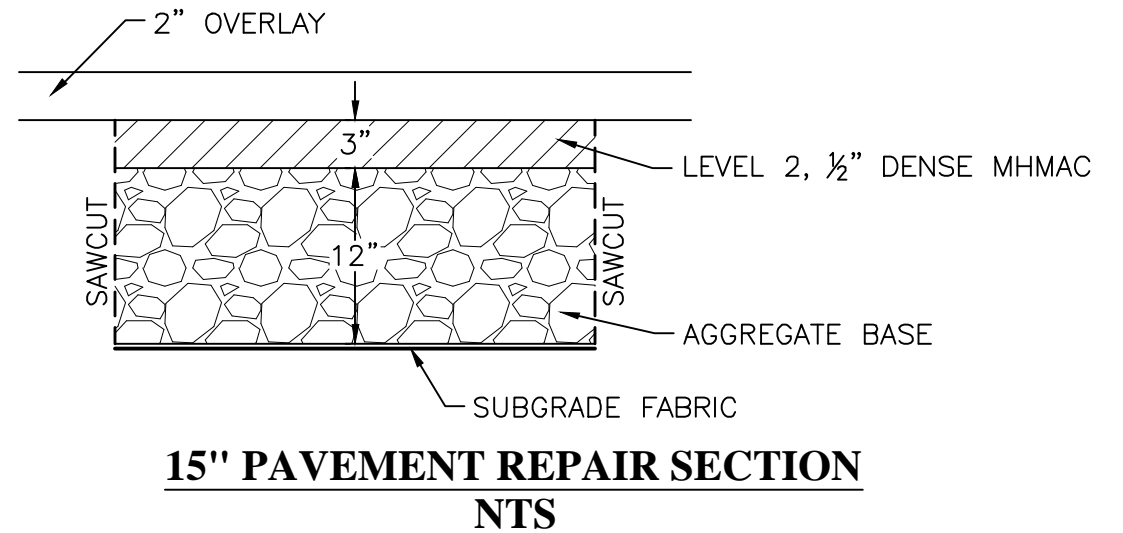

TERRACE LANE
ROADWAY IMPROVEMENTS
SUTHERLIN, OREGON

1209-33

SHEET NO.

INDEX

C2

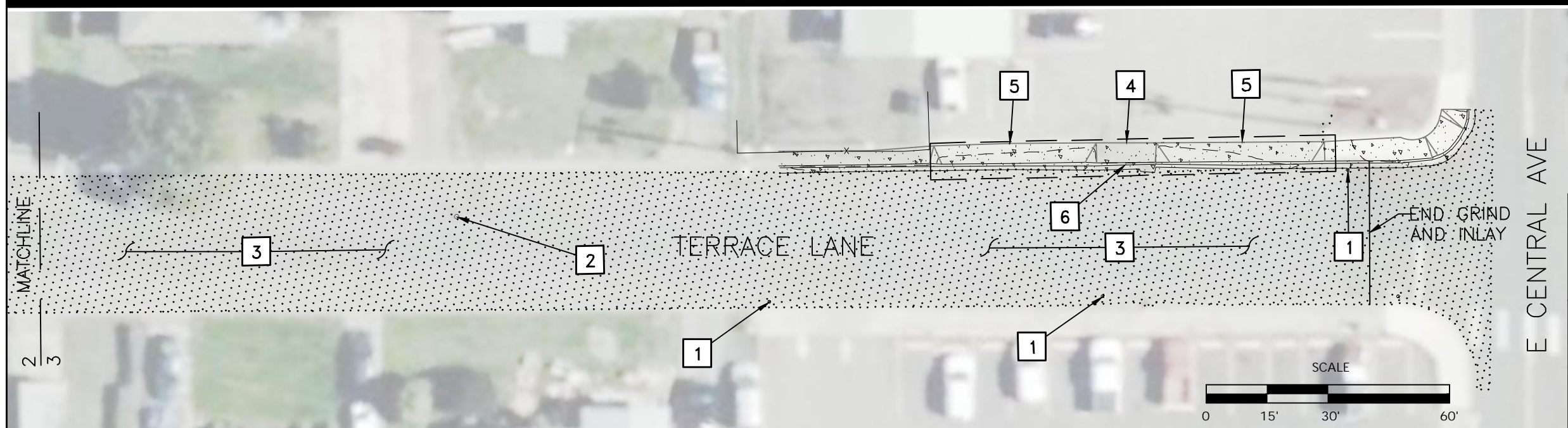
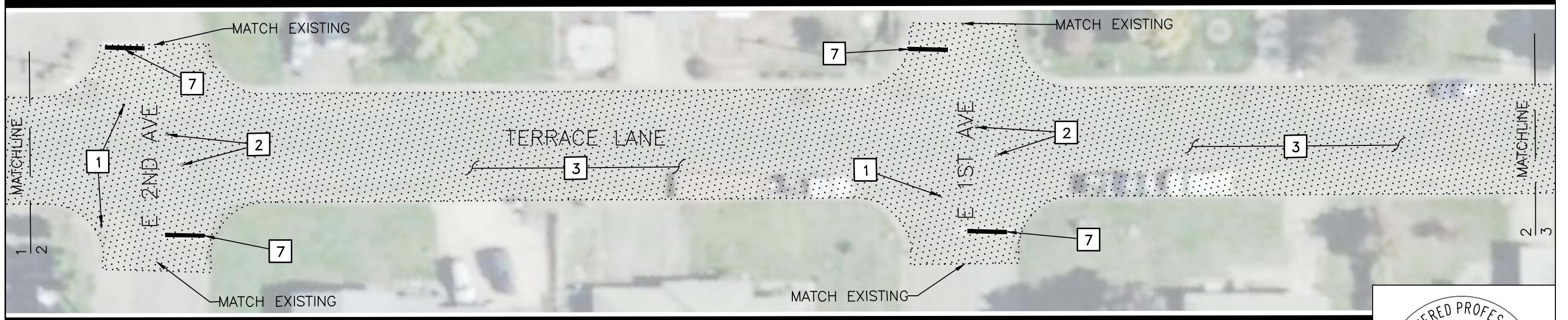
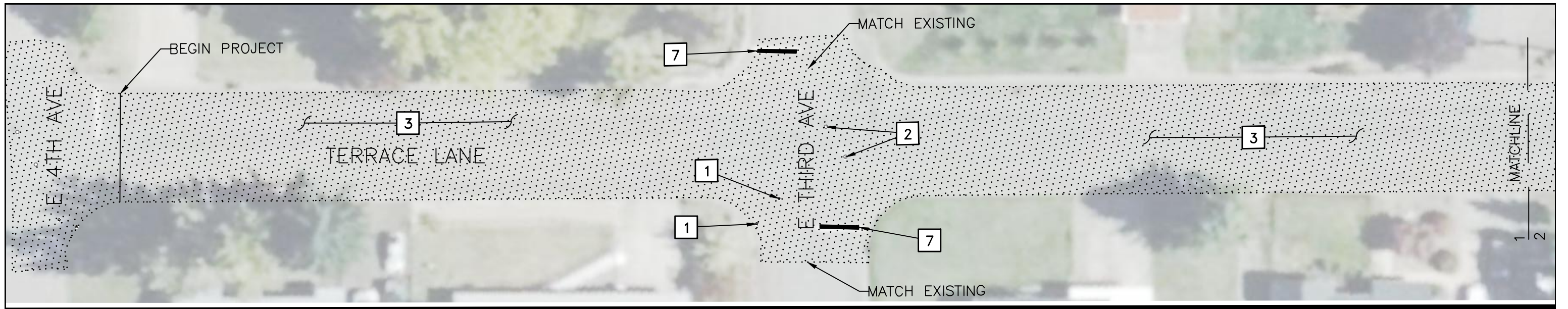

76.6'

REGISTERED PROFESSIONAL
ENGINEER
72679PE

OREGON
NOVEMBER 13, 2007
E. R. I. K. D. RANGER

EXPIRES: 12/31/2024

PLANS PREPARED FOR
SUTHERLIN, OREGON
BY:
ie 809 SE Pine Street Roseburg, Oregon 97470
PHONE (541) 673-0166 FAX (541) 440-9392
iemail@ieengineering.com

**TERRACE LANE
ROADWAY IMPROVEMENTS**
SUTHERLIN, OREGON

SCALE: 1" = 30'	PROJECT NUMBER 1209-33	SHEET NO. C3
-----------------	---------------------------	-----------------

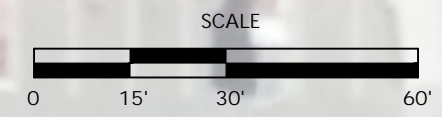

GENERAL NOTES:

1. ALL ASPHALT SAWCUTS FOR ADA RAMP AND DRIVEWAY CONSTRUCTION TO BE 2' FROM LIP OF GUTTER OR AS DIRECTED FOR GRADING. ALL REPLACEMENT ASPHALT IN RIGHT OF WAY TO BE 6" THICK, 1/2" DENSE GRADED, LEVEL 2 HMAC PLACED IN TWO, 3" THICK LIFTS.
2. WASH CONCRETE TRUCKS AND TOOLS AND EQUIPMENT OFF SITE, AT AN APPROPRIATELY PROTECTED AREA, OR IN DESIGNATED, CONTAINED, LEAK PROOF CONCRETE WASHOUT AREAS. WASHING OUT DIRECTLY ONTO THE GROUND IS NOT ALLOWED.
3. INSTALL INLET PROTECTION AS REQUIRED. FOR GRATED CATCH BASINS USE TYPE 3, PREFABRICATED FILTER INSERTS PER RD1010, AND FOR CURB INLETS, USE CURB INLET SEDIMENT DAMS-TYPE 10.
4. CONTRACTOR TO PROVIDE TRAFFIC AND PEDESTRIAN CONTROL PLAN.

KEYED PAVING NOTES: #

1. ADJUST VALVE BOX TO GRADE WITH 4" THICK, 24" SQUARE COLLAR (FOR DETAILS, SEE OR STD DWG RD258).
2. ADJUST MANHOLE FRAME TO GRADE, METHOD "B" (FOR DETAILS, SEE OR STD DWG RD360).
3. GRIND EXISTING AC 0-2" AND INLAY 2" THICK LEVEL 2, 1/2" DENSE GRADED HMAC
4. REMOVE AND RECONSTRUCT SIDEWALK (FOR DETAILS, SEE OR STD DWG RD720 & RD722)
5. CONSTRUCT TYPE M DRIVEWAY (FOR DETAILS, SEE OR STD DWG RD750)
6. CONSTRUCT CURB AND GUTTER (FOR DETAILS, SEE OR STD DWG RD700)
7. INSTALL 1' WIDE STOP BAR, TYPE B (FOR DETAILS, SEE OR STD DWG TM503)



	PLANS PREPARED FOR SUTHERLIN, OREGON BY:	
	809 SE Pine Street Roseburg, Oregon 97470 PHONE (541) 673-0166 FAX (541) 440-9392 iemail@ieengineering.com	
TERRACE LANE ROADWAY IMPROVEMENTS SUTHERLIN, OREGON		
	PROJECT NUMBER 1209-33	SHEET NO. C4